

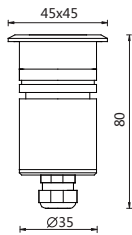

LED mini inground light with simple & elegant design, different beam angle of optical lens are optional from narrow beam to flood beam, It's widely used for plaza, park, shopping center, path, courtyard as well as the highlight of sculpture decoration & outdoor wall etc...

- Pure aluminium housing.
- PVC pre-installation housing.
- Anodised finishing.
- Excellent control of glare light.
- Remote led driver is required.
- 3V,350mA is optional.
- Easy for installation and maintenance.



Product Description:

Ref.No	Watts (W)	Beam angle (°)	Output Lumens (lm)	CCT (K)	Input Voltage (DC V)	CRI (Ra)	Weight (KG)
85029228	1	10	65	2700/3000/4000	24	>80	0.18
85029238	1	25	65	2700/3000/4000	24	>80	0.18
85029248	1	40	65	2700/3000/4000	24	>80	0.18
85029258	1	60	65	2700/3000/4000	24	>80	0.18
85029298	3	10	100	2700/3000/4000	24	>80	0.18
85029308	3	25	100	2700/3000/4000	24	>80	0.18
85029318	3	40	100	2700/3000/4000	24	>80	0.18
85029328	3	60	100	2700/3000/4000	24	>80	0.18

* Ra90 or above is on request.
 * Other CCT are available upon request.
 * Lumen output is concerned with different CCT.

pre-buried box

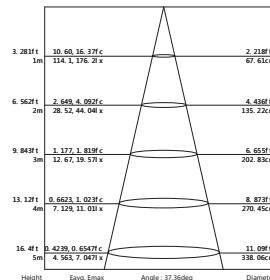
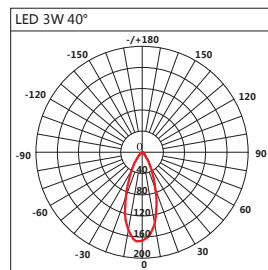
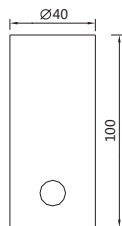

*IES files of different beam angle are available upon request.